

1. What's in the Box

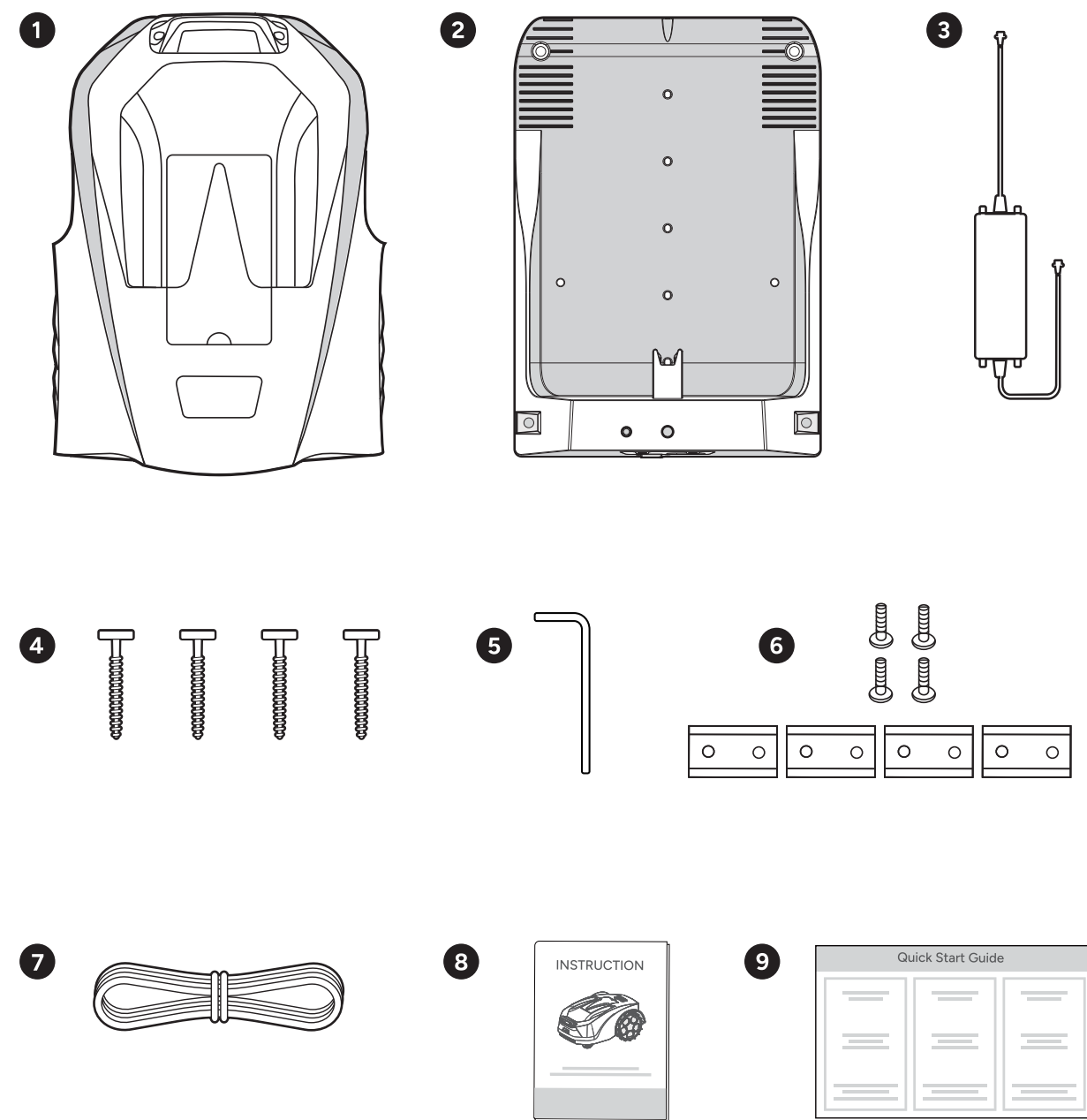

- 1 Lawn mower
- 2 Charging station
- 3 Power adapter
- 4 Mounting screws
- 5 Hex key
- 6 Extra blades
- 7 Charging station extension cable (10 m)
- 8 Instruction
- 9 Quick start guide

2. Install the Charging Station

- 1 Place the charging station in an open, level area with no slope.

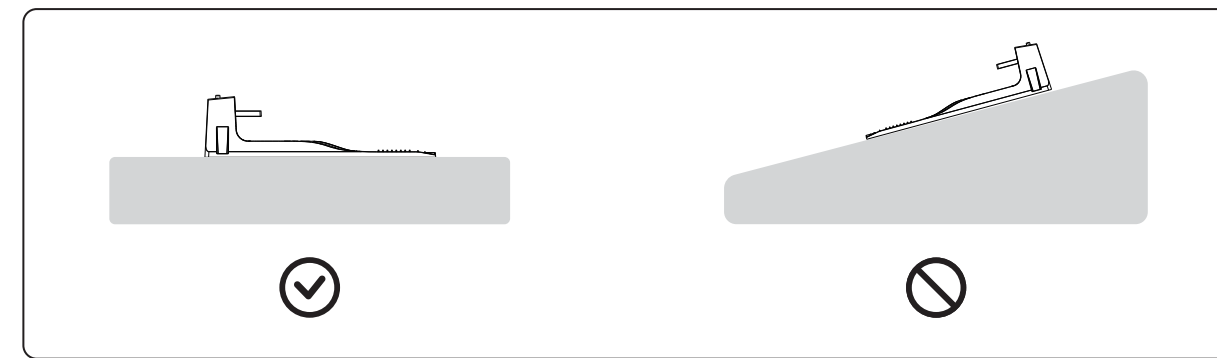
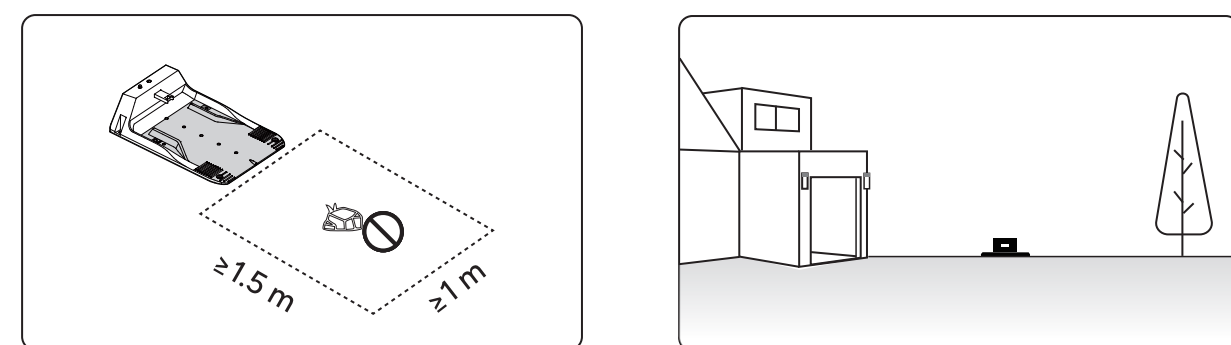

- 2 Connect the power adapter to the charging station first, then plug the adapter into an AC outlet.

NOTE: Align the notch (A) on the adapter with the tab (B) on the charging station.

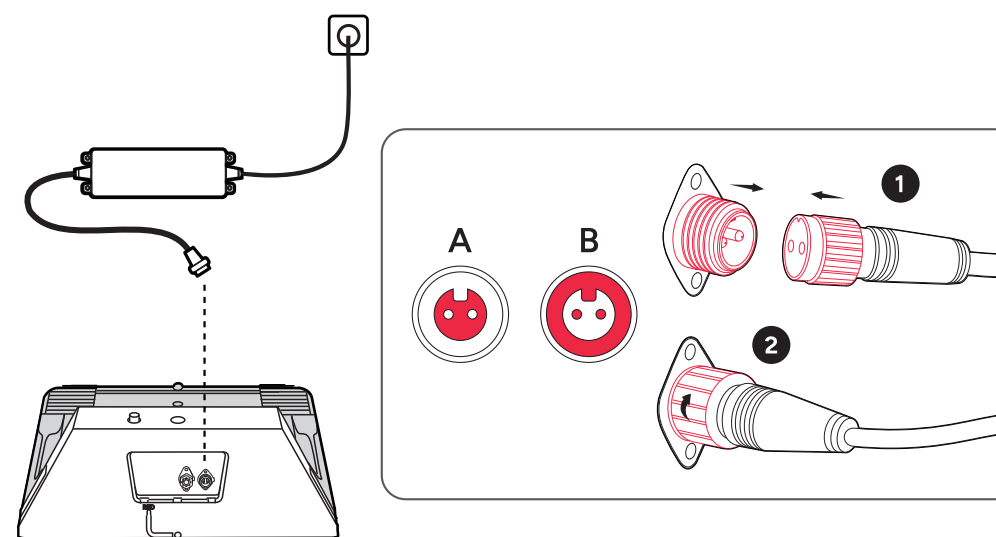

- 3 Make sure the indicator light on the charging station is green.

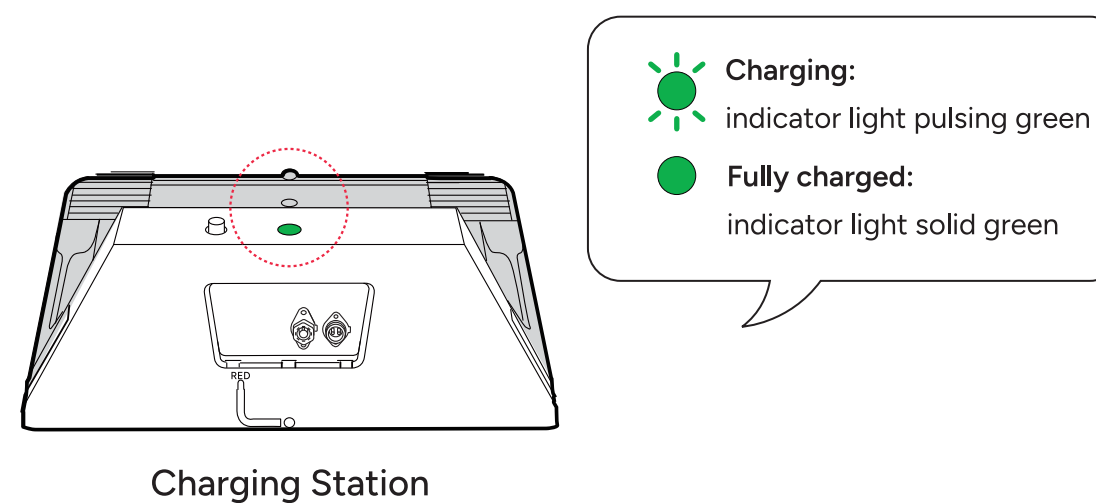

- 4 Secure the charging station to the ground with the supplied mounting screws.

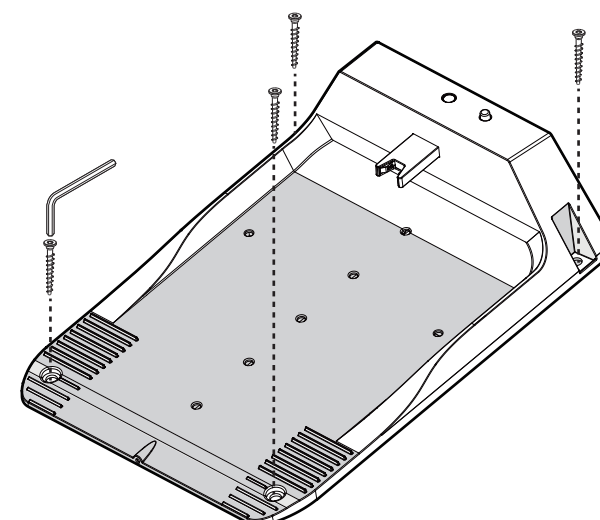

3. Dock the Mower & Set the PIN Code

- 1 Place the mower in the charging station in the direction of the arrow.

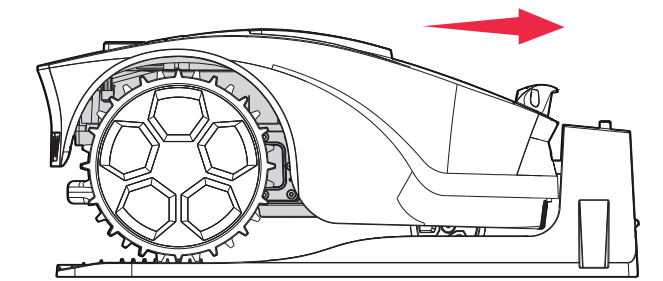

- 2 Open the control panel cover. Press OK and select your language.

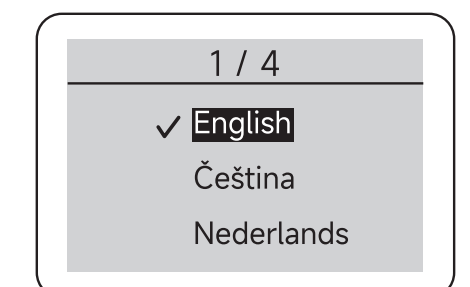
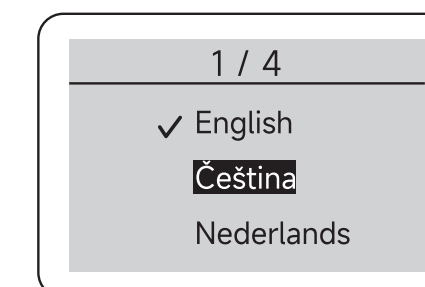
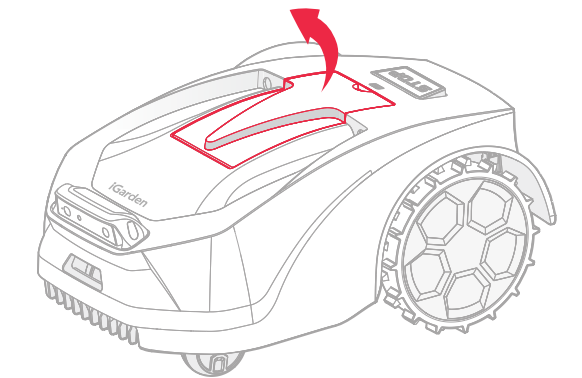

Press MOW to select each digit (0-9). Press OK to move to the next digit.

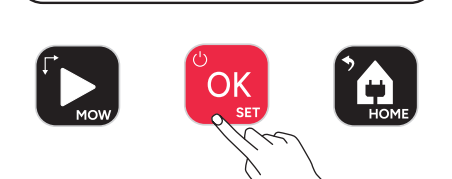
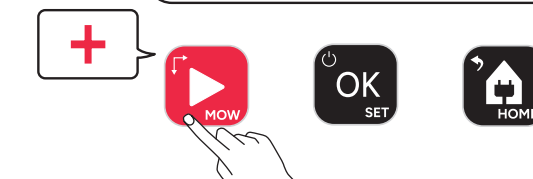
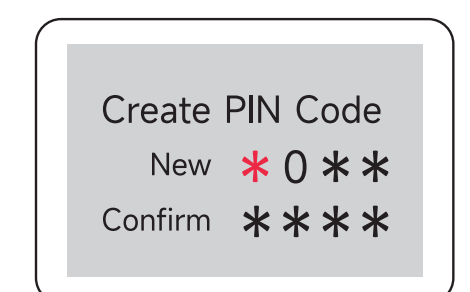
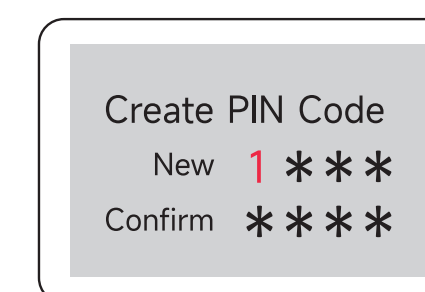

Re-enter the PIN to confirm.

Press OK to complete the setup.

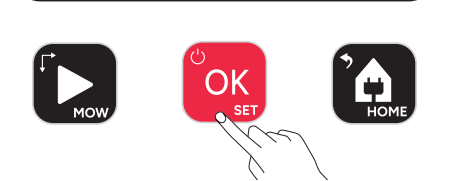
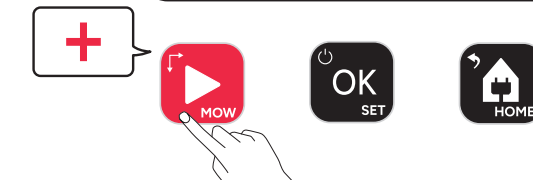
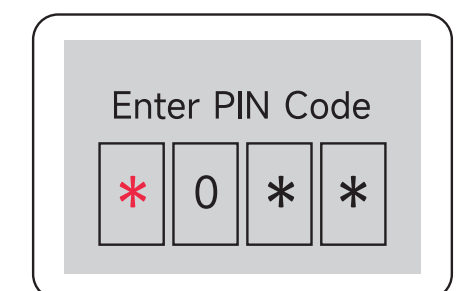
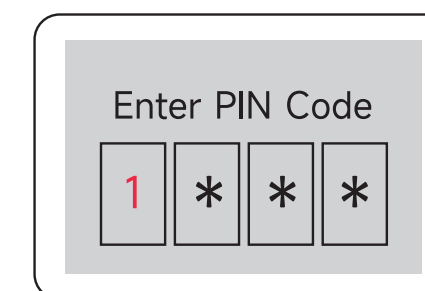

3 Control Panel and Button Overview

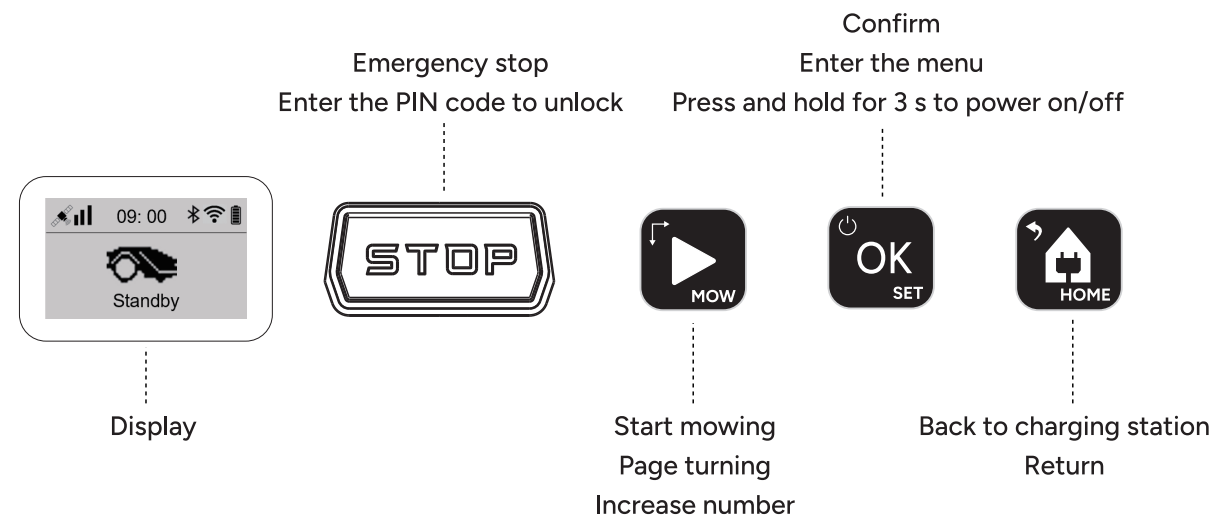

Control Panel	Operation
Power on / Power off	Press and hold OK SET for 3 sec.
Start mowing	Press MOW and then OK SET .
Return to charging station	Press HOME and then OK SET .
Stop mower operation	Press STOP .
Unlock the mower	Enter the PIN code.

4. App Download & Setup

1 Scan the QR code to download the iGarden App.

You can also download the App from the Apple App Store or Google Play. After installing the App, register and log in. Follow the App prompts to add the device and start using the mower.



2 App Pairing

1. Make sure the mower is powered on.
2. Turn on Wi-Fi and Bluetooth on your phone.
3. Stay within 5 m (16 ft) of the mower.
4. Connect the phone to the same Wi-Fi network the mower will use.
5. Open the iGarden App → Home → select your mower model. Enter the Wi-Fi network name and password to pair. You can also choose a Bluetooth connection if needed.

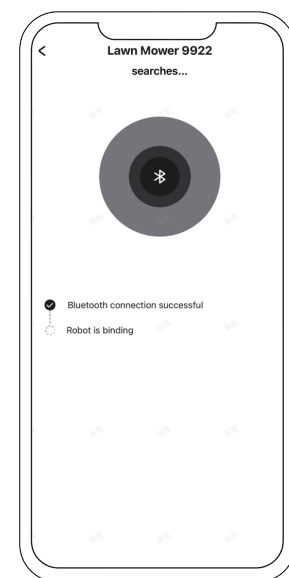

3 Device Page Overview

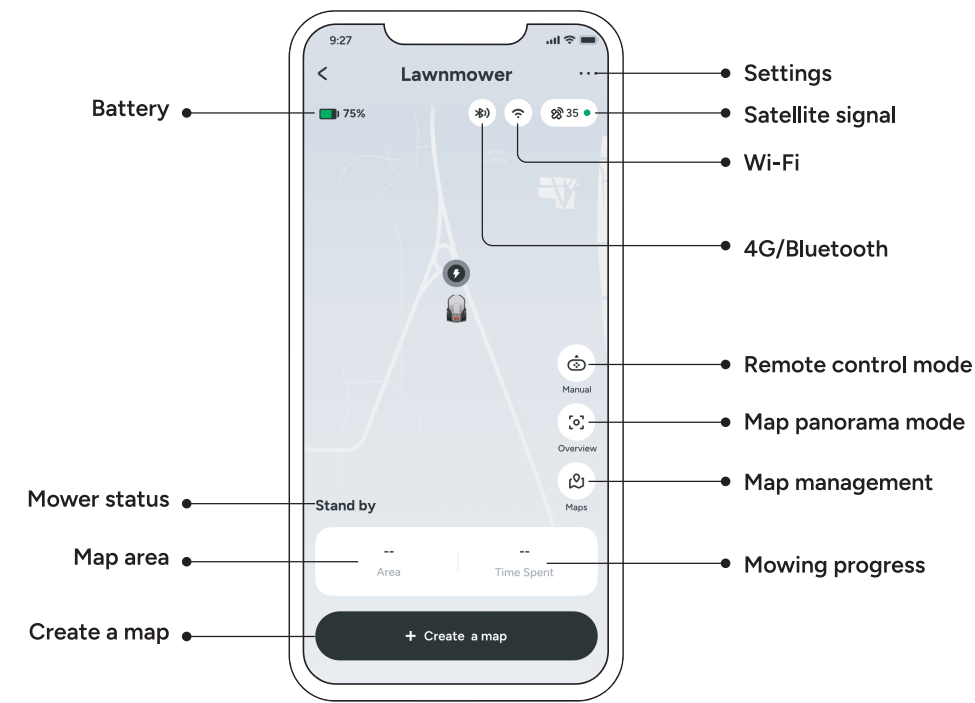

5. Map Setup

1 Before Mapping

! Important: Prepare the lawn before mapping. Read the precautions below before starting.

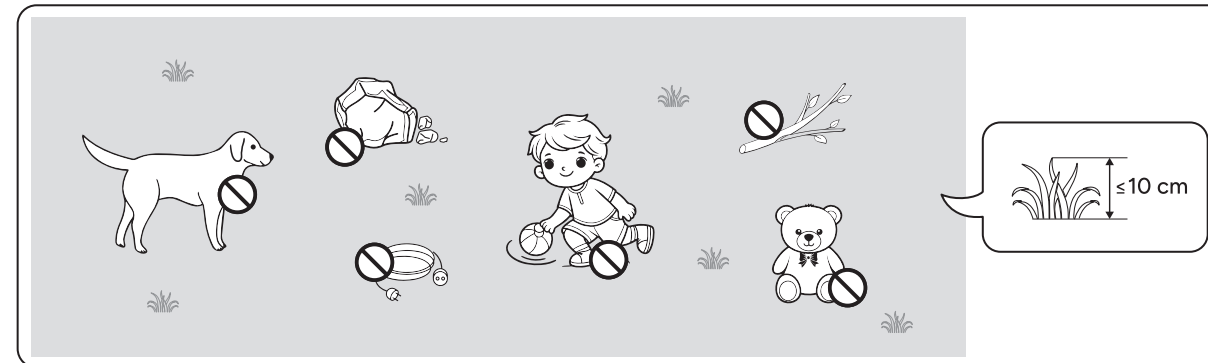

Remove leaf piles, debris, toys, wires, stones, and other obstacles. Make sure children and pets are kept off the lawn. Please cut your lawn to a height of no more than 10 cm.

1. Connect the mower to the charging station.

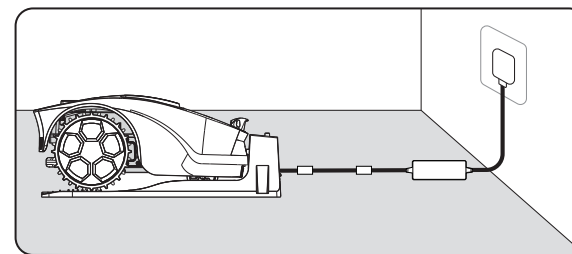

2. Ensure the battery level is at least 50%.

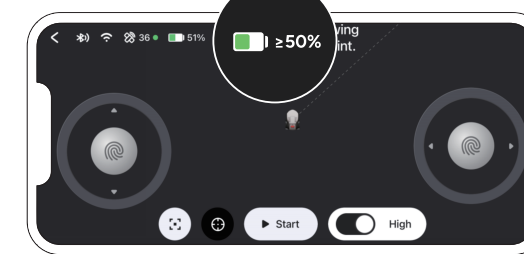

3. Do not move the mower manually during mapping.

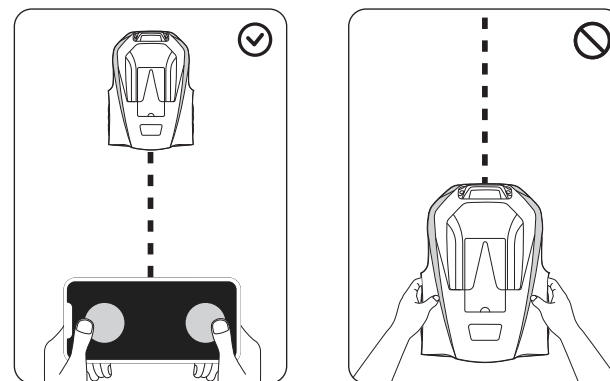

4. Stay within 6 m (20 ft) of the mower during mapping.

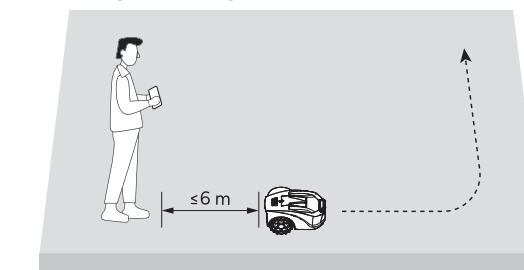

6. Maintain a 10 cm (4 in.) distance from the boundary if an obstacle is higher than 2.5 cm (1.0 in.) or a depression is deeper than 2.5 cm (1.0 in.).

5. The charging path should be at least 80 cm (2.6 ft) wide.

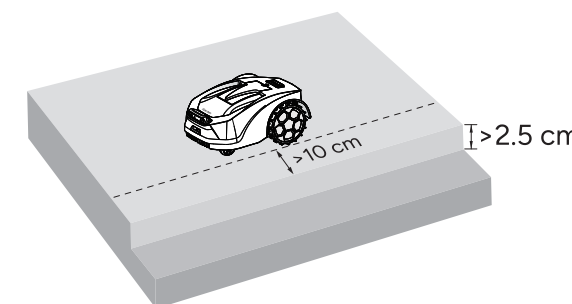
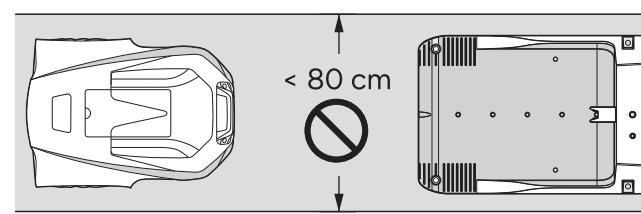

7. Ensure the turning angle is greater than 90°.

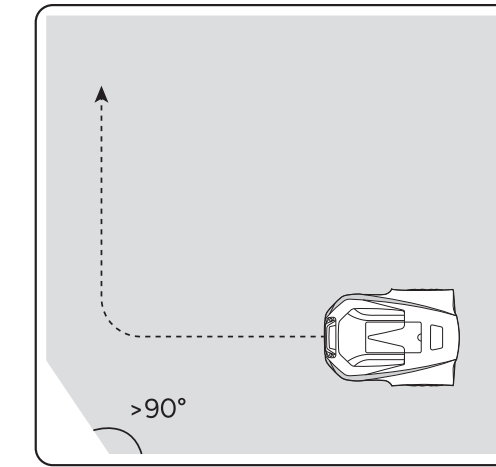

8. Do not operate the mower using the control panel during mapping.

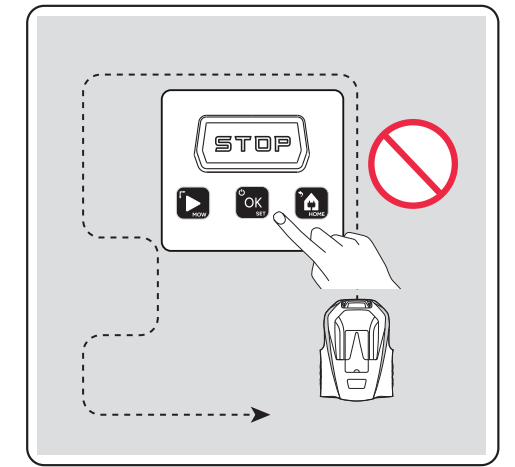

2 Create a Mowing Area

In the iGarden App, tap "Create Map". Note: The mower will leave the charging station.



3 Create No-Go Zones

Tap "No-Go Zone". Note: Create No-Go Zones for obstacles with a diameter greater than 60 cm.

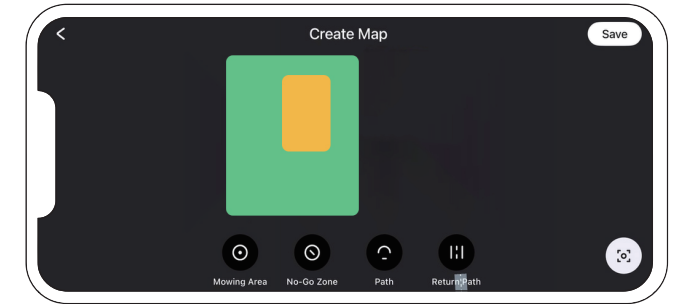

4 Add Mowing Areas

Tap "Mowing Area" if you have more than one separate lawn.



5 Create a Path to Link Mowing Areas

Tap "Path".

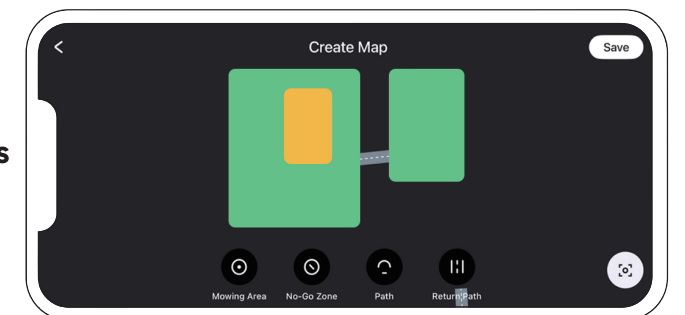

6 Create a Return Path

Tap the "Return Path" icon. Note: Make sure the paths you create are wider than 60 cm and free of obstacles or bumps.

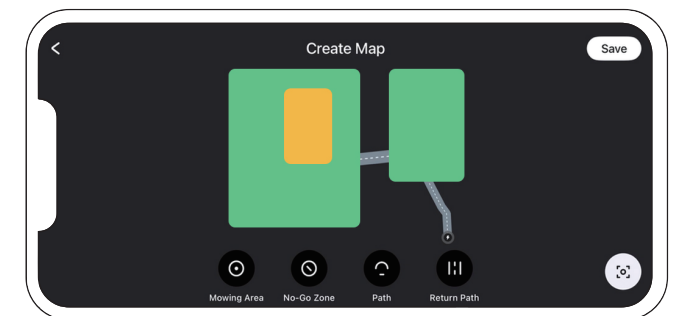

7 Tap "Save" to complete map creation.

For details, see "Map Setup" in the manual.

! Caution: Follow the official instructions provided by iGarden and use only iGarden-approved components.