

iGarden

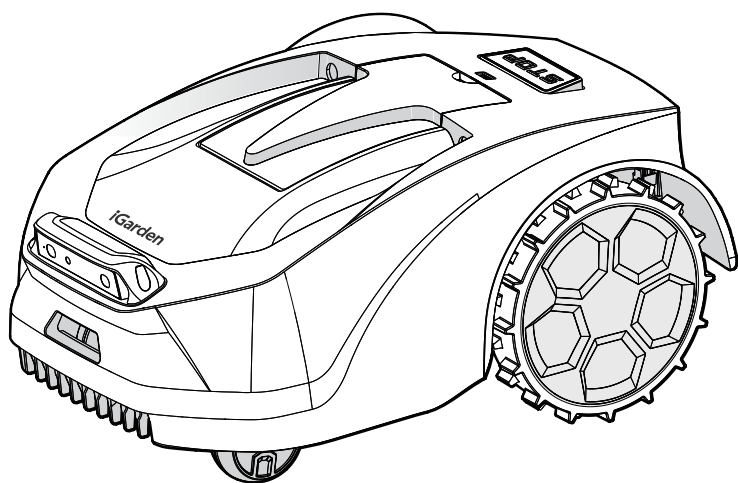

iGarden Lawn Mower R Series

— USER MANUAL —

Please read this manual carefully before installing and operating your lawn mower, and keep this manual for future reference to ensure safe and effective use.

Table of Contents

SECTION 1. SAFETY INSTRUCTIONS

01

- 1.1 General Safety Instructions
- 1.2 Safety Installation Instructions
- 1.3 Safety Operation Instructions
- 1.4 Battery Safety

SECTION 2. PRODUCT OVERVIEW

03

- 2.1 Introduction
- 2.2 What's in the Box?
- 2.3 Symbols on the Product
- 2.4 Parts and Functions
- 2.5 Introduction to Control Panel
- 2.6 Product Specifications

SECTION 3. INSTALLATION

11

- 3.1 Preparation
- 3.2 Choose a Suitable Location
- 3.3 Install the Charging Station

SECTION 4. OPERATION

14

- 4.1 Preparation
 - 4.2 Install and Pair the App
 - 4.3 Learning the App
 - 4.4 Upgrade Firmware
 - 4.5 Create a Map
 - 4.6 Mowing Mode
 - 4.7 Settings
-

SECTION 5. MAINTENANCE

26

5.1 Maintenance Schedule

5.2 Clean the Mower

5.3 Replace the Blades

5.4 Battery

SECTION 6. TROUBLESHOOTING

31

6.1 Abnormal Messages

6.2 Error Messages

6.3 Symptoms

SECTION 7. STORAGE AND DISPOSAL

35

7.1 Storage

7.2 Disposal

SECTION 8. WARRANTY

36

SECTION 9. WIRELESS MODULE SPECIFICATION

38

SECTION 10. SUPPORT

40

SECTION 11. DECLARATION OF CONFORMITY41

SECTION 1. SAFETY INSTRUCTIONS

1.1 General Safety Instructions

- Operate, maintain, and repair the product only if you are fully trained and familiar with its functions and safety requirements. Read and understand all instructions before use.
- The product is designed for lawn mowing only. Do not use it for any other purpose.
- Do not allow children or individuals with reduced physical, sensory, or mental capabilities to operate the product. Local age restrictions may apply.
- When used in public areas, warning signs should be placed around the work zone. The sign should state: "Warning! Automatic lawn mower! Keep away from the machine! Supervise children!"
- Except for the basic maintenance outlined in this manual, all service work must be performed by qualified technicians.
- Switch the mower OFF before performing any permitted adjustments or maintenance. Always use appropriate personal protective equipment, especially protective gloves when handling blades.
- Do not use the product if any part is defective.
- Improper installation or operation may result in serious injury or property damage.
- Use only manufacturer-approved accessories and components.
- Use only the supplied battery charger and power supply. Incorrect use may cause electric shock, overheating, or battery leakage. If battery liquid contacts skin or eyes, rinse immediately and seek medical help.
- Do not connect the power supply if the plug or cord is damaged; have it replaced by authorized personnel.
- Do not modify the product. Any modifications are at the user's risk.
- The illustrations in this manual are for reference only. Please refer to the actual product.

1.2 Safety Installation Instructions

- Follow all manufacturer instructions and comply with local installation regulations. The manufacturer is not responsible for damage resulting from non-compliance.
- Do not install the charging station or accessories under or within 60 cm/24 in. of combustible materials to avoid potential fire hazard.

- Avoid installing the charging station in areas with pests or standing water.
- Do not place the charging station where it may pose a tripping hazard.
- Keep all power cables outside the mowing area. Position the power supply above ground and away from water exposure.

1.3 Safety Operation Instructions

- Do not use the mower when people—especially children—or animals are in the work area.
- Remove stones, branches, toys, and other debris from the lawn. If the mower hits an object, switch it off, remove the obstruction, and ensure safety before restarting.
- Supervise the mower when operating in areas not enclosed by a climb-resistant fence.
- Keep away from the rotating blades. Do not place your hands or feet near or under the product when it is switched on.
- Do not allow anyone to sit on the mower.
- Do not lift the mower while the blade is running.
- Do not use the product if the STOP button is defective.
- Always switch the mower OFF when it is not in operation.
- If the mower vibrates abnormally, switch it OFF immediately and inspect it for damage.
- Do not use the mower if any external parts are damaged. Replace parts as needed.
- Inspect the blades, mounting screws, and cutting mechanism regularly. Replace worn components and tighten all fasteners as required.
- Avoid operating the mower near pop-up sprinklers. Do not schedule mowing and irrigation at the same time.
- The operating temperature range is 0–55 °C. The charging temperature range is 5–45 °C. Excessive temperatures can damage the mower.
- For best performance, mow only in dry weather. Do not operate the mower in heavy rain, snow, or severe weather.
- Do not use the mower during thunderstorms. Disconnect the charging station if storms are expected.
- Do not operate the mower in areas with standing water.
- Do not place any objects on top of the mower, charging station.

1.4 Battery Safety

- Use only original batteries supplied by the manufacturer.
- Lithium-ion batteries may explode or cause a fire if they are disassembled, short-circuited, or exposed to water, fire or high temperatures. Do not disassemble the battery. Store it away from direct sunlight.
- Do not charge the mower if the underside is wet. If flooding occurs, move the mower to a dry location immediately.
- Battery replacement must be performed only by qualified technicians.

KEEP THE ABOVE SAFETY INSTRUCTIONS FOR FUTURE REFERENCE

SECTION 2. PRODUCT OVERVIEW

2.1 Introduction

This product features an advanced, wire-free robotic mowing system with virtual boundaries, smart App control, and an intuitive interface.

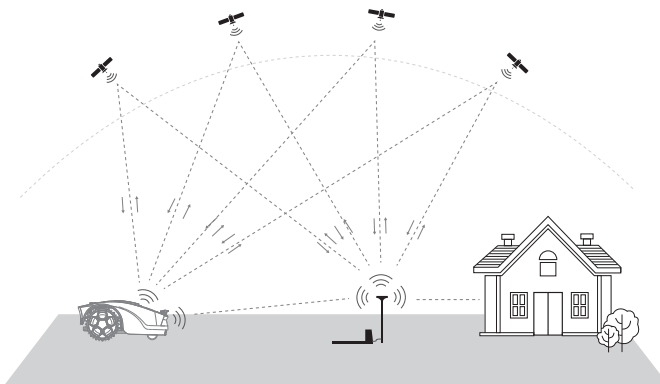





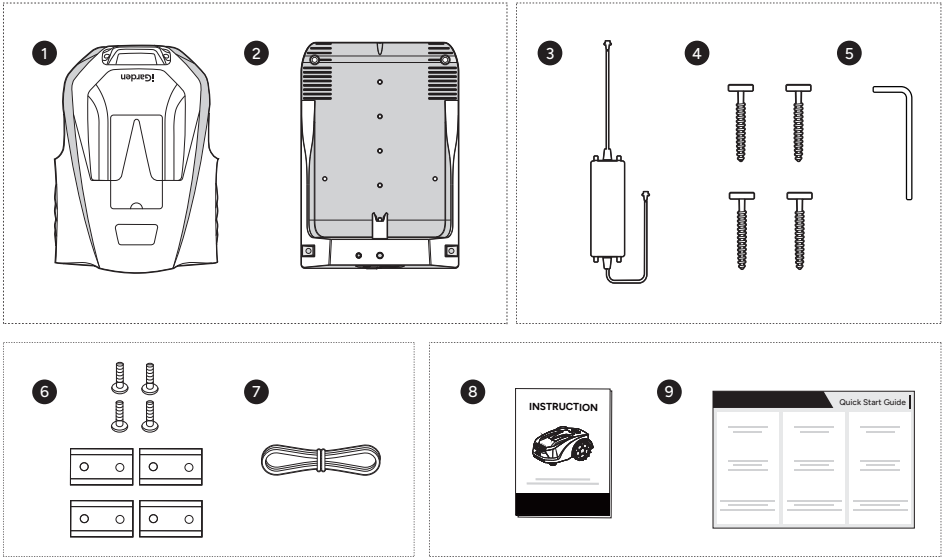



2.2 What's in the Box?

Check that all parts for your model are included. If anything is missing or damaged, contact your seller. Keep the packaging for future transport.



1 Lawn mower	6 Extra blades
2 Charging station	7 Charging station extension cable (10 m)
3 Power supply	8 Instruction
4 Fixing screws	9 Quick start guide
5 Hex key	

2.3 Symbols on the Product

Symbols	Description
	WARNING — Read user instructions before operating the mower.
	WARNING — Stop the machine before servicing or lifting the mower.
	WARNING — Keep a safe distance from the mower when operating.
	WARNING — Do not ride on the mower.
	WARNING — Do not touch the rotating blade.
	It is not permitted to dispose of this product as normal household waste. Ensure that the product is recycled in accordance with local legal requirements.
	This product conforms to the applicable EC Directives.
	This product conforms to the regulations of Restriction of Hazardous Substances.

2.4 Parts and Functions

2.4.1 Mower

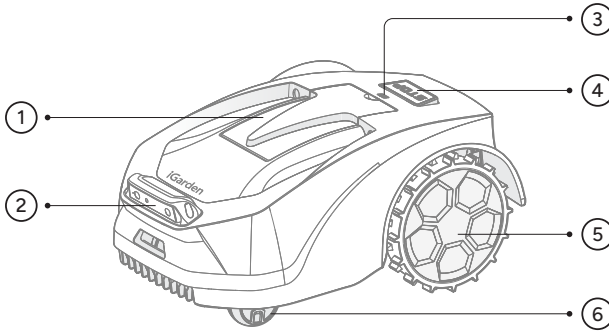

① Control panel cover	② Camera sensor	③ Rain sensor
④ Stop button	⑤ Rear wheel	⑥ Front wheel

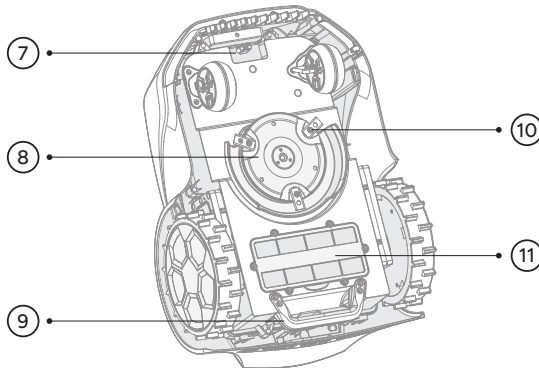

⑦ Charging contacts	⑧ Blade disc	⑨ Lifting handle
⑩ Blades	⑪ Battery cover	

2.4.2 Charging Station

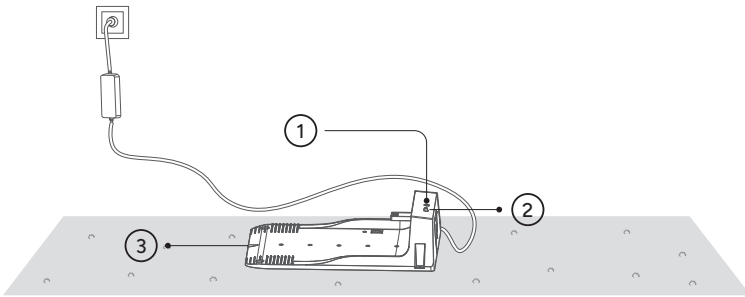

① Charging station LED indicator	② Charging station button	③ Charging station
----------------------------------	---------------------------	--------------------

Charging station indicator	Meaning
Flashing green	The mower is charging in the charging station.
Solid green	Mower is fully charged in the charging station.
Flashing green (3 times) then pausing	Press the button to start one-touch recall.
Flashing red	The wire underneath the charging station is disconnected.

2.5 Introduction to Control Panel

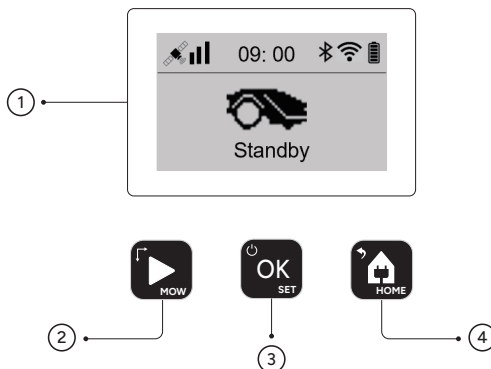

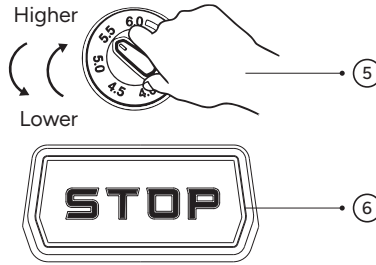

① Display	② Start mowing Page turning Plus number	③ Confirm Enter the menu Press 3 s to power on/off
④ Back to charging station Return	⑤ Cutting height adjustment	⑥ Emergency Stop Input the PIN code to unlock

Operation Flow

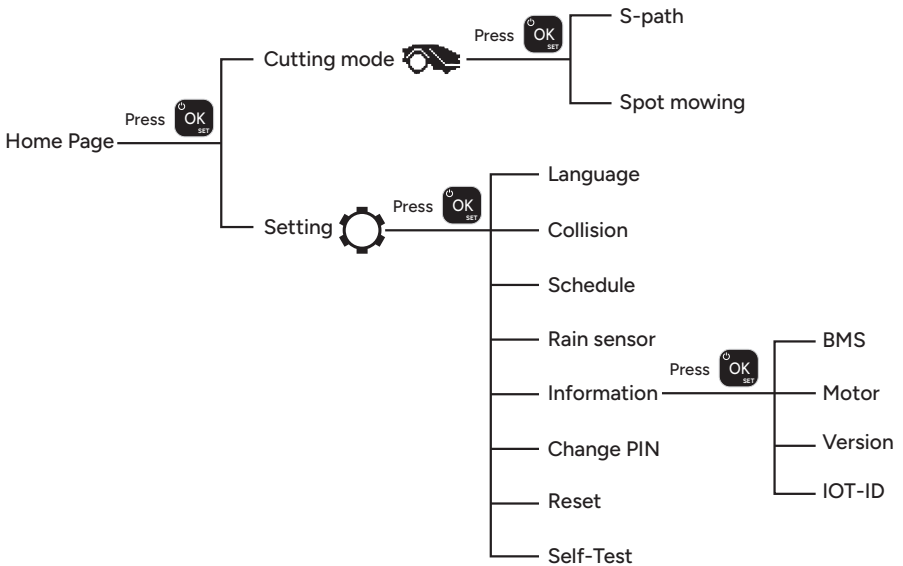

First Use Introduction

Power on the mower and complete the initial setup. Press MOW to change the numbers and press OK to confirm the code. If you forget your PIN code, please contact your seller.

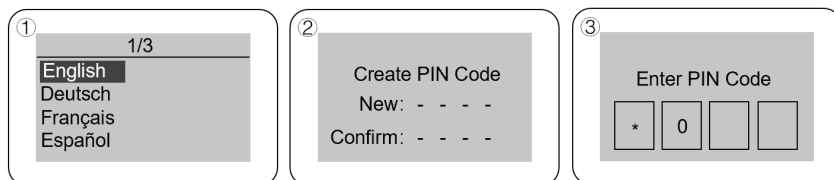

2.6 Product Specifications

Model	R35	R55
Maximum Area, m ²	≤800	≤1500
Mowing Time, h	3.5	5.5
Intelligence		
Max.map management	10	30
Max.Multi-zone management	10	30
Positioning & Navigation	RTK & Vision	
Obstacle Avoidance	Binocular Vision + RGB	
Animal Friendly Algorithm	Yes	
APP / WiFi / Bluetooth	Yes	
4G	1Y	
Net RTK Service	1Y	
Anti-theft PIN Protect	Yes	
Power System		
Battery Type	Li-ion	
Battery Capacity, Ah	6	10
Battery Voltage, V	21	
Charging Current, A	4	
Charging Time, h	1.5	2.5

Cutting System		
Blade	3	
Cutting Blade Speed, rpm	2600-3000	
Cutting Height, mm	30-60	
Cutting Width, mm	180	
Motion System		
Drive System	Two-Wheel + Gearbox Motor	
Moving Speed, m/s	0.3-0.5	
Max Slope	46% (25°)	
Features		
Sound Level, dB(A)	55	
IP Rating	IP66	
Dimensions, mm	558*400*251	
Net Weight, KGS	10	10.5
Gross Weight, KGS	21	
Working Temperature, °C	0-55	
Charging Temperature, °C	5-45	
Storage Temperature, °C	-20-60	
Charging Station Extension Cable, m	10	

Mowing Time: Tested at a moving speed of 0.3 m/s with a full battery at an ambient temperature of 25 °C, while mowing a freshly cut, flat lawn.

SECTION 3. INSTALLATION

3.1 Preparation

- Plan the working area before installation.
- Make sure holes are filled and grass are under 10 cm (4 in.) in the working area.
- Remove leaf piles, debris, toys, wires, stones, and other obstacles. Keep children and pets away from the lawn during installation.

3.2 Install the Charging Station

- ① Place the charging station in an open and flat area with no slopes.

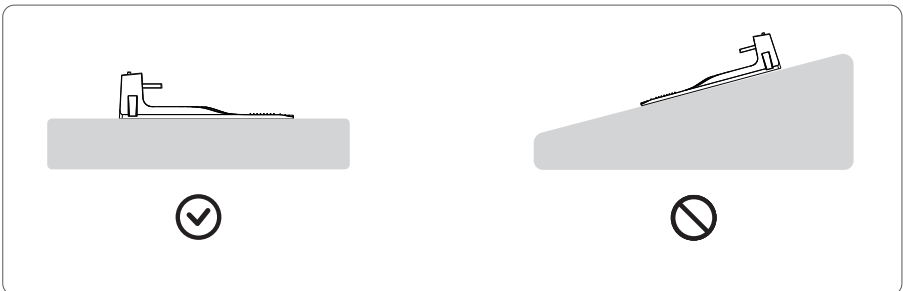
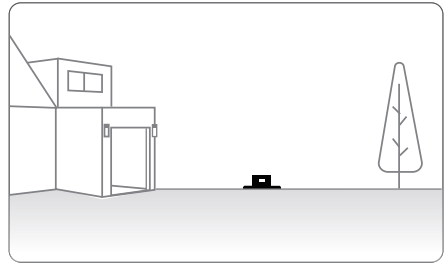
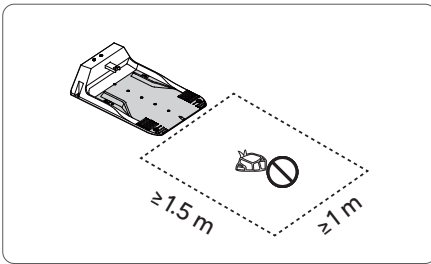

Note:

- Place the charging station away from high-power equipment to avoid interference, such as water pumps, air conditioners, substations, and generators.
- Keep it clear of sprinkler heads, fountains, and other outdoor water systems.

- ② Connect the power adapter to the charging station first, then plug the adapter into an AC outlet.

NOTE: Align the notch (A) on the adapter with the tab (B) on the charging station.

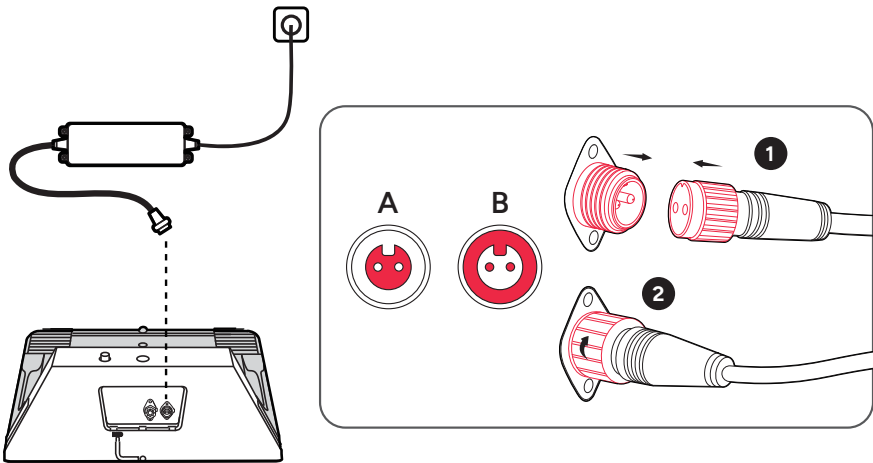

**WARNING:**

Make sure all power and extension cable plugs are clean and dry before connection.

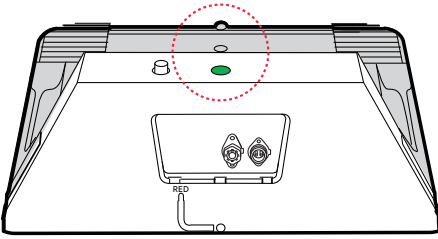
③ Make sure the indicator light on the charging station is green.



Charging Station

-  **Charging:**
indicator light pulsing green
-  **Fully charged:**
indicator light solid green

④ Secure the charging station to the ground with the supplied mounting screws.

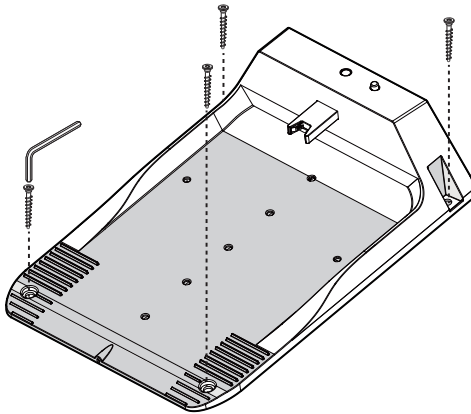

Note:

- Secure all cable connectors to prevent water ingress.
- Keep cables out of the mowing area and away from mower travel paths to avoid damage.

SECTION 4. OPERATION

4.1 Preparation

- Ensure that the charging station has been properly installed.
- Ensure that the mower is docked on the charging station and switched on.
- Ensure a stable network connection and keep Bluetooth enabled on your mobile device.

4.2 Install and Pair the App

4.2.1 Download the App

Download the App via QR code or by searching "iGarden" in the App Store or Google Play, then register and log in. Set up the mower through iGarden App.



Note:

Turn on Bluetooth, GPS, and Wi-Fi for proper operation.

4.2.2 Pair the Mower

Pair the mower before installation.

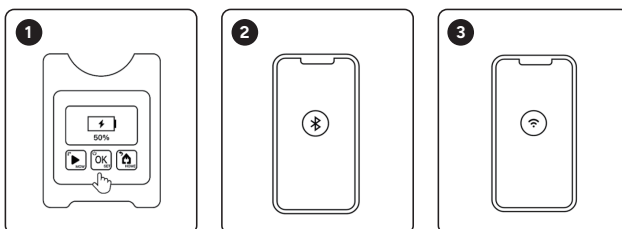

4.2.3 Add Your Mower

Open the App and tap + to add your mower. Follow the on-screen instructions to connect the device and set up the network.

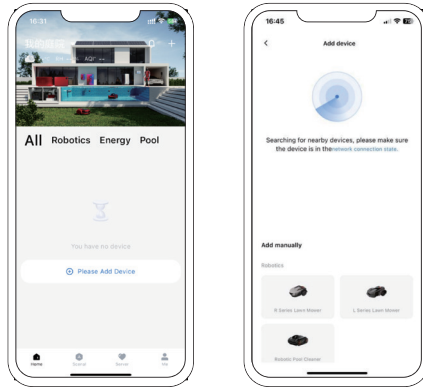

Note:

- Keep your mobile device within 3 m of the mower.
- If using 4G cellular data, skip Wi-Fi setup, but a Wi-Fi connection is recommended for optimal performance.

4.3 Learning the App

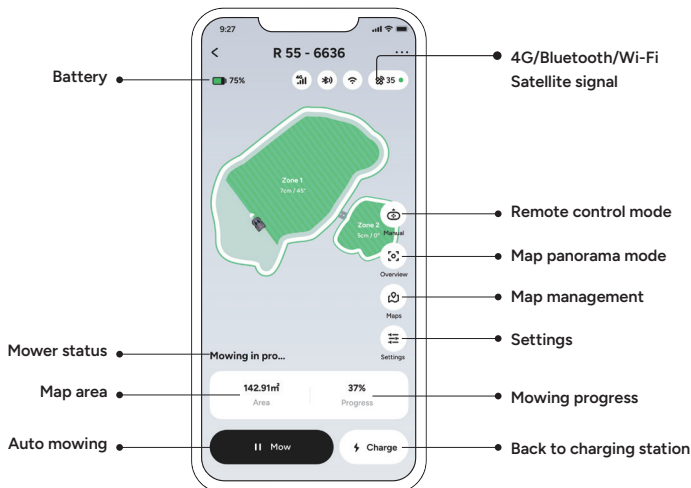

4.4 Upgrade Firmware

The iGarden lawn mower supports over-the-air (OTA) firmware updates. Keep the mower updated to ensure optimal performance.

- Go to Settings > Firmware Upgrade in the App to check and confirm the update.
- Ensure a stable network connection. Place the mower on the charging station, or make sure the battery level is above 50%.

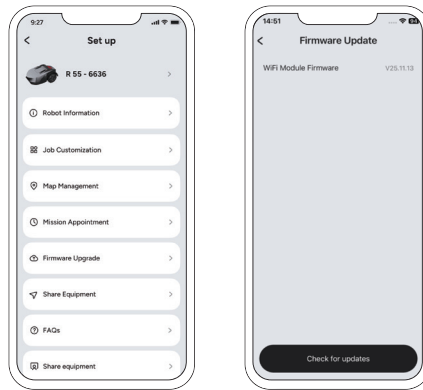

Note: Do not exit the App, power off, or operate the mower during the upgrade. Use the mower only after the App confirms the update is complete.

4.5 Create a Map

4.5.1 Preparing the Lawn for Mowing

Before mapping, prepare the lawn as follows:

- Remove obstacles from the lawn. Keep children and pets away from the mowing area.
- Trim the grass to 10 cm (4 in.) tall or less before operation.

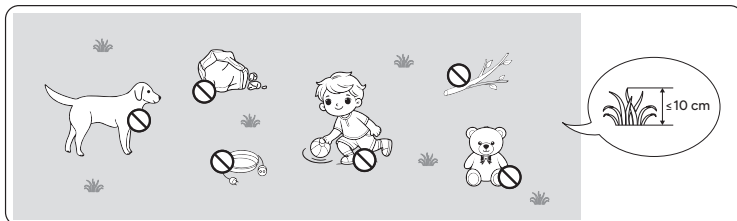

- Stay within 6 m of the mower during the mapping process for Bluetooth connection.

- Keep the mower at least 10 cm from edges when mapping along walls, fences, or obstacles.

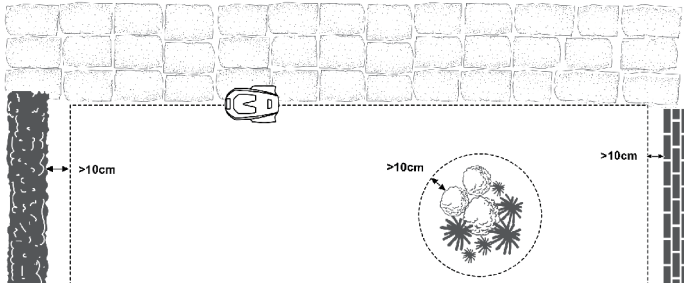

Note: To avoid positioning errors and potential damage, leave enough turning space during mapping.

- When mapping near pools, steps, slopes, or other hazards, keep the mower at least 50 cm from the edge.

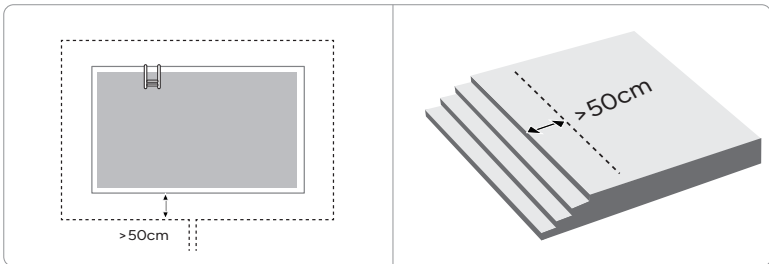

- If the hazard is bordered by a rigid fence taller than 10 cm, maintain a minimum distance of 35 cm.

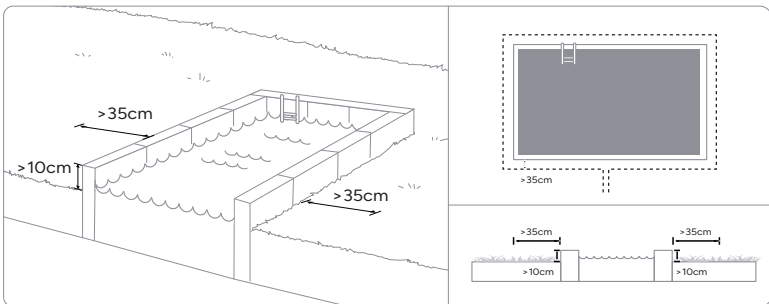

4.5.2 Creating a Mowing Area

Place the mower on charging station and set the cutting height to 6 cm. Ensure the mower is powered on and the Bluetooth is enabled. The phone will automatically connect to the mower.

- Tap Create a map, wait for self-checking to finish, then tap Start to set the mowing area starting point.

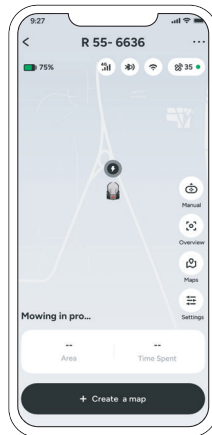

- Use the virtual joystick to move the mower forward/backward and turn left/right.

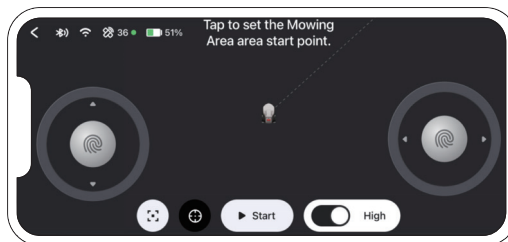

- Guide the mower along the lawn edge. Keep your phone within 6 m of the mower.

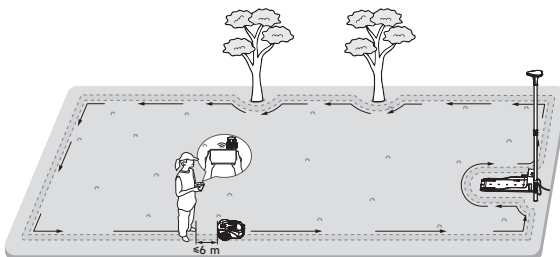

- Guide the mower back to the starting point and tap Confirm to save the boundary.

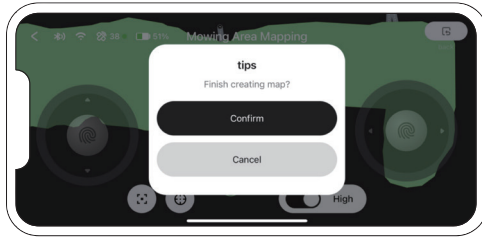

4.5.3 Creating No-Go Zones

Set up No-Go Zones in areas that may damage or trap the mower, or around objects that need protection.

- Tap No-Go Zone.

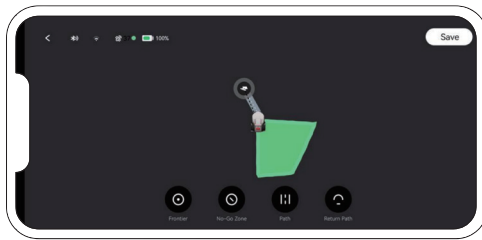

- Select a suitable starting point along the edge of the No-Go Zone and tap Start.

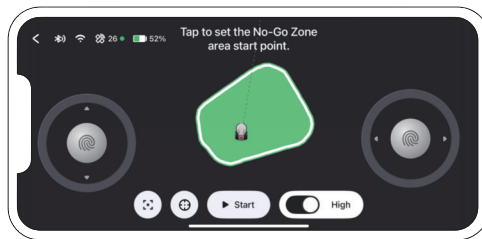

- Guide the mower along the edge of the No-Go Zone until it returns to the starting point.

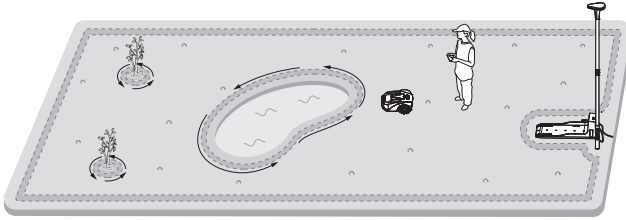

- Tap Confirm to save the No-Go Zone.

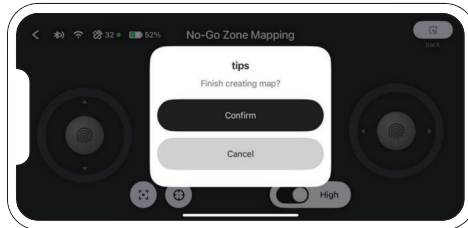

Note: The mower's camera has blind spots. Create No-Go Zones for obstacles with a diameter greater than 60 cm.

4.5.4 Linking Mowing Areas

- Tap Path.

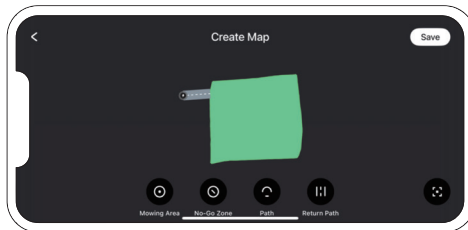

- Move the mower inside the Mowing Area A, and set a starting point.

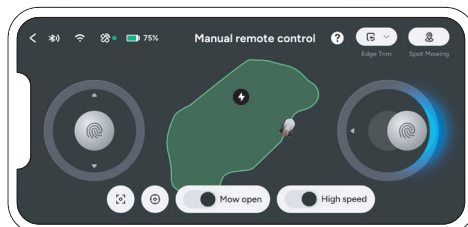

- Drive the mower from Area A to Area B to set an end point inside Area B.

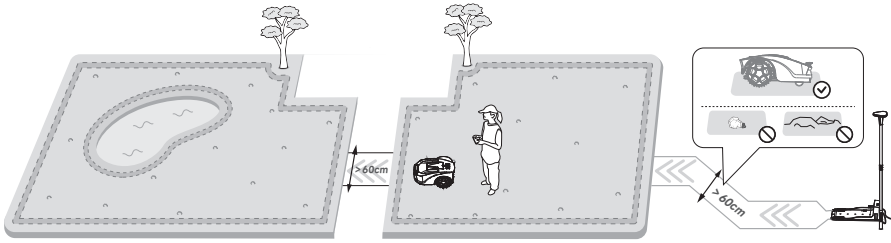

- Tap Confirm to save the path.

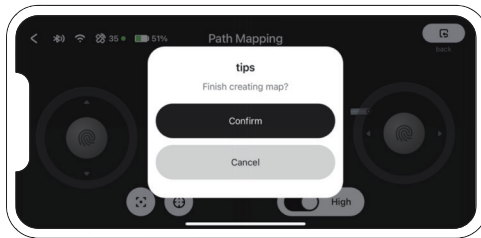

- Tap Return Path, drive the machine inside the mowing area, and set a start point.





- Tap Save to complete the creation.

Note: To ensure smooth mowing, make sure the paths you create are wider than 60 cm and free of obstacles or bumps.

4.5.5 Edit the Map

With the iGarden App, you can edit or delete map. Ensure your phone is connected to the mower via Bluetooth.

Tap the  icon on the right of the Home page to access the Map List. Tap  icon to add or delete mowing areas, No-Go zones, and paths. Deleting an area removes all included items.

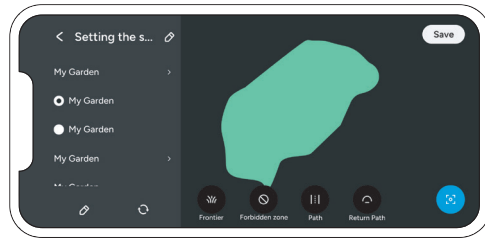

4.6 Mowing Mode

4.6.1 Auto Mowing

- After creating a mowing area, tap Mow on the Home page or control panel to start automatic mowing.
- The mower first cuts along the boundary, then follows a planned path to complete mowing. When finished, it automatically returns to the charging station.
- To reduce repeated tracks, Smart Mode alternates mowing angles (0° , 45° , and 90°), using one angle per task. You can also customize the mowing angle and spacing. Tap the  icon on the right of the Home page to set the mowing angle and spacing for the entire map or individual mowing areas.

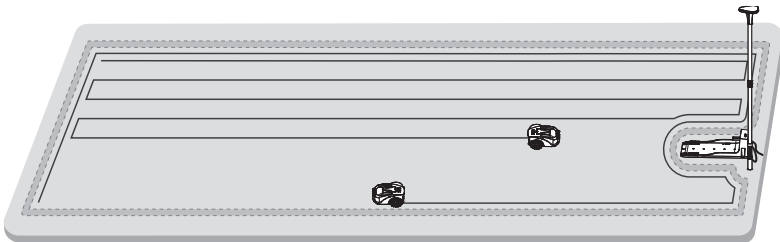

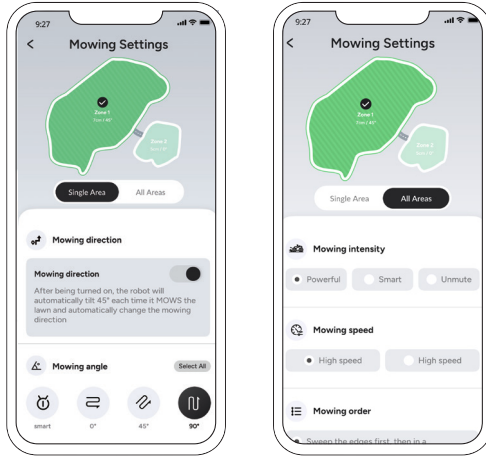



4.6.2 Manual Mowing

If you need to mow your lawn manually, you can use the Remote Control Mode, which includes Remote Mowing, Spot Mowing and Boundary Mowing.

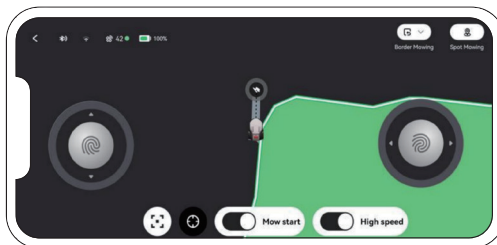
Remote Mowing: Tap  icon at the bottom-right of the Home page to enter the Remote Mowing mode. Use the virtual joystick to move the mower to your desired starting point, then turn on the Mow Switch below to begin manual remote mowing.



Spot Mowing: Move the mower to a location with no obstacles within 1.5 m around it as the starting point. Tap  icon at the upper-right corner of the Remote Control page to enter Spot Mowing mode.

The mower will create a 3 × 3 m square centered on the starting point and mow it automatically.



Boundary Mowing: To prevent the mower from getting stuck on uneven terrain or in bushes near the boundary while mowing in a bow-shaped pattern, it will mow 20 cm inside the mapped boundary. According to your lawn's needs, you can go to the Remote Control page, click the  button, and select 1/2/3 cycles along the boundary. Each cycle will move inward 9 cm. After clicking, the mower will perform a single boundary mowing task for the selected number of cycles.

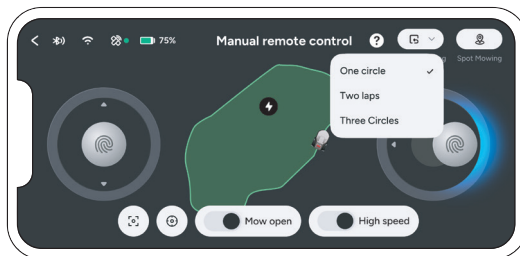

4.7 Settings

Tap **...** icon at the upper right corner of the Home page to enter the Settings page.

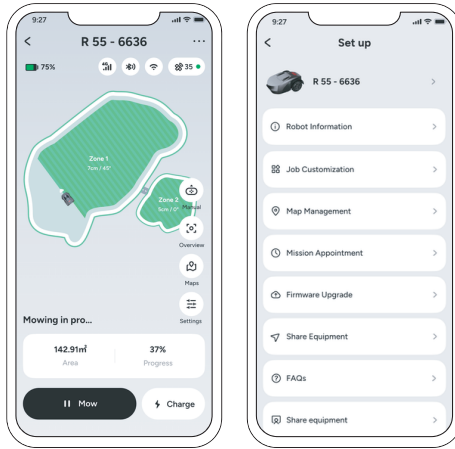

4.7.1 Robot Information

On the Robot Information page, you can view the device ID, log, error messages, and change the PIN.

4.7.2 Work Customization

On the Work Customization page, you can adjust the mower's settings, including Mowing Mode, Mowing Speed, Unit of Temperature, Crash Sensitivity, Camera Switch, Location Method, Rain Sensor, Rain-Delayed Mowing, Digitally Transmitted Pairs.

4.7.3 Map Management

On the Map Management page, you can manage all the maps created by the mower, and switch the default display map.

4.7.4 Mowing Schedule

On the Mowing Schedule page, you can set a regular mowing schedule, and the mower will automatically operate according to your settings.

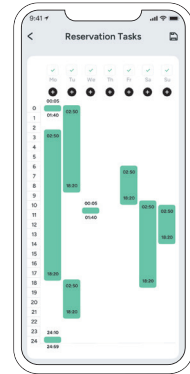

4.7.5 Share Equipment

On the Share Equipment page, you can share the mower with family members and revoke access at any time.

SECTION 5. MAINTENANCE

**WARNING:**

Use protective gloves during maintenance, especially when operating the blade.

**WARNING:**

Before carrying out any type of maintenance, make sure the mower is turned off.

Clean the mower regularly and replace worn parts to maintain performance and extend service life. For advanced maintenance, contact your seller.

5.1 Maintenance Schedule

Frequency	Part	Type of maintenance	Reference
Weekly	Blades	Clean and check the efficiency of the blades. Replace if bent or badly worn.	See "5.3 Replace the blades".
	Camera sensor	Clean dirt from the camera lens.	See "5.2.4 Camera Sensor".
	Rain sensor	Clean and remove any rust.	See "5.2.5 Rain Sensor".
	Charging contacts	Clean and remove any rust.	See "5.2.6 Charging Contacts".
Semimonthly	Mower bottom	Clean the mower bottom.	See "5.2.1 Bottom".
	Mower wheels	Clean the mower wheels.	See "5.2.2 Wheels".
Monthly	Mower	Clean the mower.	See "5.2 Clean the Mower".
Every year	Mower	Have the mower serviced at an authorized service center.	See "7.1 Storage".

5.2 Clean the Mower

**CAUTION:**

Do not use a high-pressure water jet to clean the mower and charging station.

**CAUTION:**

Do not use solvents or polishers for cleaning to avoid potential damage.

**CAUTION:**

The control panel cover must be closed before cleaning and do not rinse the screen directly to avoid damaging the mower.

- The mower and charging station are rated IPX6 and may be rinsed with a low-pressure hose.
- For best results, remove grass clippings and mud with a brush or cloth before rinsing.
- Do not clean the internal parts of the mower, as this may damage electrical and electronic components.

5.2.1 Bottom

- Switch off the mower and clean it with a brush and hose.
- After cleaning, ensure the blade disc and blades rotate freely.

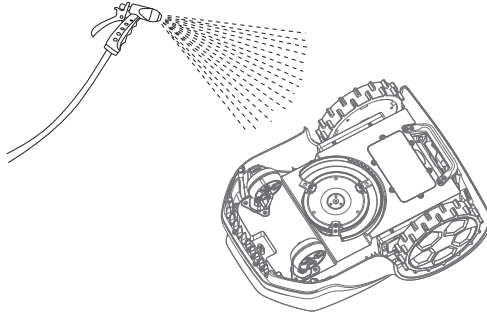

Note: After mowing wet grass, clean the underside of the mower immediately.

5.2.2 Wheels

- Remove mud and grass from the wheels with a brush and water to maintain good wheel traction.
- Replace the front wheels every 2–3 years to ensure proper mower operation.

Note: After mowing a wet lawn, clean the wheels immediately.

5.2.3 Body

- Clean the body of the mower with a rag and water.
- Do not use solvents or polishers to avoid potential damage.

5.2.4 Camera Sensor

- Regularly clean the camera sensor lens with a soft cloth to remove dirt.
- Ensure the lens is free of dirt to maintain obstacle avoidance and proper operation.

Note: Be careful not to scratch or damage the camera sensor lens when cleaning.

5.2.5 Rain Sensor

- Regularly clean the rain sensor with a rag and remove any oxides.
- Prevent rust on the rain sensor caused by long-term exposure to moisture, especially on rainy days.

5.2.6 Charging Contacts

**WARNING:**

Disconnect the power before maintenance or cleaning the charging station.

- Clean the charging contacts on the mower and charging station with a cloth and water.
- Regularly remove grass clippings and dust around the charging contacts to ensure the mower charges properly each time.

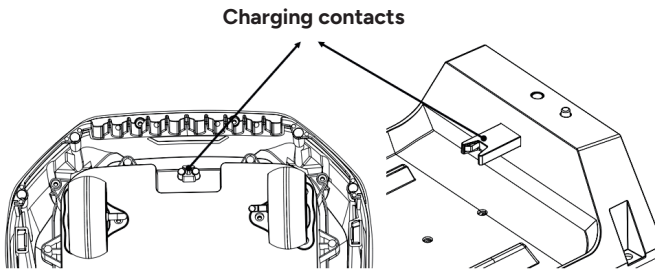

5.3 Replace the Blades

**WARNING:**

Replace the worn or damaged blades with original spare parts.

**WARNING:**

All blades and screws must be replaced at the same time to ensure the cutting system is balanced and to avoid serious injury.

- Switch off the mower.
- Turn the mower upside down and place it on a protective surface to avoid scratches.

- Before removing or installing screws, insert a long screwdriver to secure the blade disc and avoid accidental rotation.
- Use a straight slot or cross-tip screwdriver to remove the screws.
- Remove the worn blade and install a new one.
- Use a straight slot or cross-tip screwdriver to tight the screws, make sure that the blades can pivot freely.

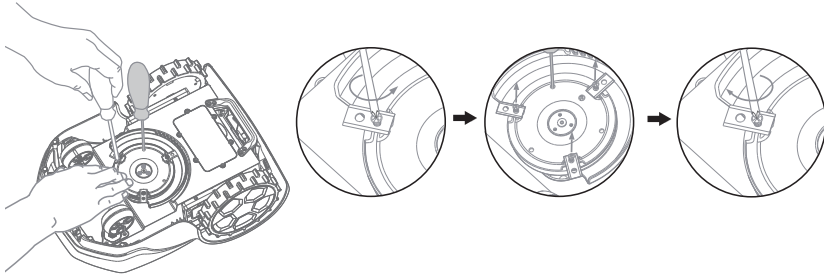

Note: Blades typically last 1–3 months. Replace them regularly to maintain cutting performance and energy efficiency.

5.4 Battery



CAUTION:

If the mower is not used for a long time, it is recommended to fully charge it at least every six months to protect the battery.

- Do not use or store the battery at temperatures above 55 °C or below -20 °C. Store the battery in a cool, dry place, and have it replaced by an authorized seller if necessary.
- Temperature protection is activated at 0 °C / 47 °C. Charging resumes only when the battery temperature is between 5 - 45 °C.
- The battery's lifespan depends on the length of the mowing season and daily operating hours. Longer use may require more frequent battery replacement.
- If operating time is reduced, the battery may be at the end of its service life. Replace the battery to extend the operating time.

SECTION 6. TROUBLESHOOTING

For additional troubleshooting, including product/application-related problems and frequently asked questions, go to [iGarden App > Serve > User manual > Q&A](#).

6.1 Abnormal Messages

Message	Cause	Solution
Mower lifted, please press "the "OK" button within 10 min and wait for auto mowing.	The mower's two front wheels have triggered consecutive lifts.	Move the mower to a flat area with no obstacles or low ground. Press the OK button on the mower to continue operation. If the issue persists, restart the mower.
Slip detected, mower stopped, please press the "OK" button and wait for auto mowing.	The mower has slipped four times consecutively.	Press the OK button on the mower's display to automatically resume operation. If more than 10 minutes pass, the mower will enter sleep mode and must be manually moved to the charging station.
Collision detected, mower stopped, please press the "OK" button within 10 min and wait for the auto mowing.	The mower has triggered four consecutive collisions.	Ensure there are no obstacles or low ground. Press the OK button on the mower to continue operation. If the issue persists, restart the mower.
Mower overturned, please remote control the robot to return to the charging station.	The front wheels were lifted to 35° for 3 seconds or more than 55°, causing the mower to stop immediately.	Move the mower to a flat area. Press the OK button on the mower to continue operation. If the issue persists, restart the mower.
Recharge failed, please manually place the robot into the charging station.	The mower failed to automatically recharge even after 5 attempts to return to the charging station.	Manually push the mower into the charging station and check the following: 1. Ensure the charging station is correctly placed and not blocked by obstacles. 2. Check for foreign objects in the charging port that may cause poor contact. If the issue persists, restart the mower.
Charging station unknown, please remote control the robot to return to the charging station.	The mower was not on the charging station when powered on.	Push the mower into the charging station manually or remotely and press the OK button on the mower to continue operation. If the issues persists, please restart the mower.
Positioning failed, please remote control the robot to return to the charging station.	The mower's camera positioning is lost, or combined navigation data has timed out.	Push the mower into the charging station manually or remotely, then resume operation. If the issue persists, please restart the mower.

Failed to escape, please press "the ok" button in 10 min and wait for the auto mowing.	The mower is trapped and has stopped after four failed attempts to extricate itself.	Assist the mower out of the trapped area and press the OK button on the mower to continue. If the mower frequently gets stuck in the same area, set the area as a No-Go Zone or level gaps and uneven areas.
E-Stop	The STOP button is held down.	Enter the PIN code to unlock and eliminate the message. Check if the STOP button is accidentally pressed; if so, remove the obstruction.If the issue persists, restart the mower.
Cannot spot mowing on charging station	The mowe started a spot mowing operation while on the charging station.	Move the mower to a location outside the charging station and select spot mowing.

6.2 Error Messages

Message	Cause	Solution
Lift sensor error, please restart the mower.	The mower reports a front wheel lift hall fault at the charging station.	Check for foreign objects stuck in the front wheels and remove them. Press the STOP button to clear the error message. If it does not work, restart the mower. If the error persists, contact after-sales service.
Left motor error, please press the 'STOP' button and enter the PIN.	Overvoltage/undervoltage/overcurrent/blockage/loss of connection/hall abnormality in the mower's left rear wheel motor.	Check for foreign objects stuck in the left rear wheel and remove them. Press the STOP button to clear the error message. If it does not work, restart the mower. If the error persists, contact after-sales service.
Right motor error, please press the 'STOP' button and enter the PIN.	Overvoltage/undervoltage/overcurrent/blockage/loss of connection/hall abnormality in the mower's right rear wheel motor.	Check for foreign objects stuck in the right rear wheel and remove them. Press the STOP button to clear the error message. If it does not work, restart the mower. If the error persists, contact after-sales service.
Blade motor error, please press the 'STOP' button and enter the PIN.	Overvoltage/undervoltage/overcurrent/blockage/loss of connection/hall abnormality in the mower's cutting motor.	Power off the mower immediately. Then, check the following information to resolve the issue: 1. Check if the blade disc is stuck. If yes, remove any foreign objects. 2. Check if the grass is too thick; cut it to no more than 10 cm. Restart the mower and resume mowing. If the error persists,contact the after-sales service.
Chassis disconnected, please wait for re-connection.	No communication between the mower's chassis MCU and the task computer.	Restart the mower. If the error persists, please contact the after-sales service to check the software and hardware.

Camera error, please restart the mower.	The mower's camera has malfunctioned and cannot communicate with the mainboard.	Restart the mower. If the error persists, please contact the after-sales service to check the hardware.
EM sensor error, please check the charging station.	The mower cannot detect the auxiliary return coil signal at the bottom of the charging station and the coil is disconnected.	Check the coil connection at the bottom of the charging station and reconnect it if it is disconnected. If the error persists, please contact the after-sales service to check the hardware.
IMU sensor error, please restart the mower.	The mower IMU has no data or incorrect data.	Restart the mower to continue operation. If the error persists, please contact the after-sales service.

Note: If an error message occurs while the mower is operating and there is no timely human intervention, the mower will automatically switch off after 10 minutes.

6.3 Symptoms

Symptoms	Cause	Solution
Camera obstacle avoidance failure, please restart the mower.	The mower's obstacle-avoidance function is unavailable	Restart the mower. If the issue occurs three times in a row, contact after-sales support.
	The mower is turning or an obstacle suddenly appears.	This type of obstacle enters the visual blind spot, so in order to improve mowing efficiency and prevent missed cuts, the mower uses collision sensor for obstacle avoidance.
Mower vibrates	Blade disc unbalanced, blades may be damaged.	Inspect the blades and replace if damaged. Remove debris and foreign objects from the blades and blade disc.
Grass is being cut unevenly	The mower works too few hours a day.	Increase the mowing time.
	The blades are dull.	Replace all blades for optimal cutting efficiency.
	The cutting height is too low.	Raise the cutting height and gradually lower it.
	Grass or objects entangled in the blade disc.	Check and remove grass or objects from the blade disc.

Charging time exceeds rated time	Poor connection due to debris on charging station.	Clean the contact paddles on the charging station and the charging contacts on the mower.
	The battery temperature is too high.	Place the charging station in a shaded area or wait until the battery temperature drops.
Mower runs shorter periods between charges	Battery is old or exhausted	Contact your seller to replace the battery.
	Grass or foreign objects block blade disc, or blades are dull	Remove and clean the blade disc.
Repeated rear wheel slip	Foreign obstacles under the mower.	Remove obstacles from the bottom of the mower.
	The lawn is too wet.	Wait for the lawn to dry before mowing.
The mower parked on the lawn and switched off	Error messages occurred while mower was in operation with no human intervention.	Restart the mower, check the error log, troubleshoot the problem, and press the HOME button to return it to the charging station.

SECTION 7. STORAGE AND DISPOSAL

7.1 Storage

- Fully charge the battery before winter storage, and recharge it at least once every 6 months.
- Disconnect the power supply from the electrical outlet and unplug all cables from the charging station.
- Clean the mower and charging station. Check parts (e.g., blades) and replace if worn or damaged.
- Store the mower, charging station, in a cool, dry place at 10–20 °C, away from children, animals, and foreign objects.

To maintain optimal performance, have the mower serviced regularly by an authorized service provider. Service typically includes:

- Cleaning the mower and moving parts.
- Checking mower operation.
- Replacing worn or damaged parts (e.g., blades).
- Checking battery capacity and replacing if required.
- Updating the mower software if necessary.

7.2 Disposal

When this product reaches the end of its service life, it is classified as WEEE (Waste Electrical and Electronic Equipment) and must not be disposed of with household waste.

When disposal is required, the user must ensure that the product is recycled in accordance with the requirements of local legislation; in particular, electrical and electronic components must be separated and sorted at an authorized WEEE Waste Disposal Centre or returned to the seller at the time of purchasing a new product. Improper disposal may be subject to penalties under local law.

Note:

- **Packaging** - Users must dispose of product packaging in a sustainable manner in dedicated waste disposal containers or authorized waste disposal centers.

- Batteries - Spent or damaged batteries contain substances harmful to health and the environment.



Do not dispose of them with household waste; take them to a dedicated battery collection point or an authorized recycling center.

SECTION 8. WARRANTY

Under this Limited Warranty, this product is covered for a period of 3 years from the date of purchase against defects in materials or workmanship.

The Limited Warranty includes repair coverage for the following key components:

- Host and Core
- Charging Station
- Power Supply

Consumable Parts:

- Consumable materials (including but not limited to tires and cutting discs) are covered under the Limited Warranty for 6 months against defects in materials or workmanship.
- The battery pack is covered under the Limited Warranty for 2 years against defects in materials or workmanship.
- Blades and wheels are classified as consumable parts and are not covered under the Limited Warranty.

Examples of faults not covered by this warranty:

- Damage caused by use of a high-pressure washer, causing water ingress.
- Damage caused by not closing the control panel cover before cleaning robot and directly rinsing the screen.

-
- Damage caused by submersion in water, such as pooled water from heavy rain.
 - Damage caused by lightning.
 - Damage caused by improper battery storage or battery handling.
 - Damage caused by use of non-supplied batteries.
 - Damage caused by using non-supplied spare parts or accessories, such as blades or installation materials.
 - Damage caused by unauthorized modification or tampering with the product or its power supply.

This manufacturer's warranty does not affect any warranty entitlements you may have against the seller or retailer.

End users or unauthorized third parties must not attempt to repair the product.

If an error occurs with your product, please contact iGarden Customer Service for further instructions. When contacting customer service, have your purchase receipt and the product's serial number available.

SECTION 9. WIRELESS MODULE SPECIFICATION

BLE	Frequency Band(s)	2.402-2.480GHz
	Max. RF Power	0.53dBm
BT	Frequency Band(s)	2.402-2.480GHz
	Max. RF Power	1.58dBm
2.4G WLAN	Frequency Band(s)	2412-2472MHz
	Max. RF Power	16.01dBm
5G WLAN	Frequency Band(s)	5180MHz-5240MHz
	Max. RF Power	11.69dBm
	Frequency Band(s)	5260MHz-5320MHz
	Max. RF Power	12.75dBm
	Frequency Band(s)	5500MHz-5700MHz
	Max. RF Power	13.09dBm
	Frequency Band(s)	5745--5825MHz
	Max. RF Power	13.26dBm
GSM900	Frequency Band(s)	80-915MHz/925-960MHz
	Max. RF Power	32.60dBm
DCS1800	Frequency Band(s)	1710-1785MHz/1805-1880MHz
	Max. RF Power	29.70dBm
WCDMA	Frequency Band(s)	BAND I(1920-1980MHz/2110-2170MHz)
	Max. RF Power	21.37dBm
	Frequency Band(s)	BAND VIII(880-915MHz/925-960MHz)
	Max. RF Power	22.63dBm

LTE	Frequency Band(s)	Band 1 (1920-1980MHz/2110-2170MHz)
	Max. RF Power	25.00dBm
	Frequency Band(s)	Band 3 (1710-1785MHz/1805-1880MHz)
	Max. RF Power	25.00dBm
	Frequency Band(s)	Band 7 (2500-2570MHz/2620-2690MHz)
	Max. RF Power	25.00dBm
	Frequency Band(s)	Band 8 (880-915MHz/925-960MHz)
	Max. RF Power	25.00dBm
	Frequency Band(s)	Band 20 (832-862MHz/791-821MHz)
	Max. RF Power	25.00dBm
	Frequency Band(s)	Band 28 (703-748MHz/758-803MHz)
	Max. RF Power	25.00dBm
	Frequency Band(s)	Band 34 (2010-2025MHz)
	Max. RF Power	25.00dBm
	Frequency Band(s)	Band 38 (2570-2620MHz)
	Max. RF Power	25.00dBm
	Frequency Band(s)	Band 40 (2300-2400MHz)
	Max. RF Power	25.00dBm

SRD	Frequency Band(s)	868.1-868.5MHz
	Max. RF Power	-5.79dBm
GPS Receiver	Frequency Band(s)	1575.42MHz
	Max. RF Power	-
GLONASS Receiver	Frequency Band(s)	1602.5625MHz
	Max. RF Power	-
Galileo Receiver	Frequency Band(s)	1589.74MHz
	Max. RF Power	-
BDS Receiver	Frequency Band(s)	1561.098MHz
	Max. RF Power	-

SECTION 10. SUPPORT



Email: support@igarden.ai (AU & US) support.eu@igarden.ai (EU)



Official Website: www.igarden.ai



Toll Free: +1(888)880-3320

© 2025 iGarden All rights reserved. Version R-NetRTK Manual-V6(EN)

Full legal terms and updated specs: <https://store.igarden.ai/pages/warranty-policy>

SECTION 11. DECLARATION OF CONFORMITY

FAIRLAND GROUP LIMITED, 19H MAXGRAND PLAZA, NO.3 TAI YAU STREET, SAN PO KONG, KOWLOON, HONGKONG, declares that the robotic lawn mowers comply with the requirements of the COUNCIL ' S DIRECTIVE :

Product Name: Lawn Mower R series

Product Model Numbers: RXX,ZX,TSFXX,ZXX,AIFXX

(XX, X are variables, X can be 0~9, XX can be 01-99)

Model Similarity:All models are identical with each other except model designation and appearance.

The object of the declaration described is ensure that the models in conformity with the relevant Union harmonisation legislation:

Radio(REDD)directive 2014/53/EU, Electromagnetic compatibility directive 2014/30/EU, LVD Directive 2014/35/EU, Directive 2006/42/EC on Machinery, RoHS directive 2011/65/EU and amending directive ((EU)2015/863)

Complies with the following harmonised standards:

EN 60335-1:2012/AC:2014+A11:2014+A13:2017+A1:2019+A14:2019+A2:2019+A15:2021

EN 50636-2-107:2015/A1:2018+A2:2020+A3:2021

EN IEC 62311:2020

EN 300 328 V2.2.2

EN 301 489-1 V2.2.3

EN 301 893 V2.1.1

EN 301 489-3 V2.3.2

EN 300 440 V2.2.1

EN 301 489-17 V3.3.1

EN 301 511 V12.5.1

EN 301 489-19 V2.2.1

EN 301 908-1 V15.2.1

EN 301 489-52 V1.3.1

EN 55032:2015/A1:2020

EN 55035:2017/A11:2020

EN 301 908-2 V13.1.1

EN IEC 61000-3-2:2019/A1:2021

EN 301 908-13 V13.3.1

EN 61000-3-3:2013/A2:2021

EN 303 413 V1.2.1

EN IEC 63000:2018

EN 300 220-1 V3.1.1

EN 300 220-2 V3.2.1

(Authorized representative for FAIRLAND and responsible for technical documentation.)



Position.... head of certification

Place and Date.....: Guangzhou 2025.08.27

Name and surname.....: Eric zhang

A handwritten signature in black ink that reads "Eric zhang". The signature is written in a cursive style with a large initial 'E'.

iGarden

 www.igarden.ai



Version: R-NetRTK Manual-V6(EN)

Thank you for choosing iGarden Lawn Mower R Series.