

RTK Antenna

Quick Start Guide

Version: V1

Precautions

1. Tighten all cable connectors to prevent water ingress.
2. Do not place any objects on the RTK antenna to ensure proper satellite signal and avoid damage.
3. If you move the RTK antenna after creating a map, go to Settings > Work Customization in the App to update the antenna position.

1. What's in the Box

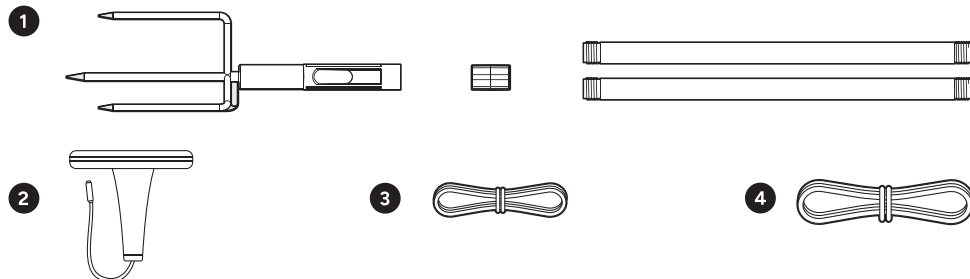

- 1 RTK antenna installation kit
- 2 RTK antenna
- 3 RTK antenna power cable (3 m)
- 4 RTK antenna extension cable (10 m)

2. Assemble the RTK Antenna

1. Assemble the two mounting poles together.

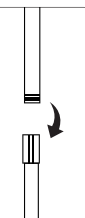

2. Thread the 3 m RTK antenna power cable through the assembled mounting pole.



3. Connect the RTK antenna to the power cable.

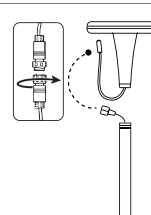

4. Screw the RTK antenna onto the mounting pole.

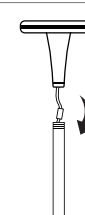

5. Thread the power cable through the base fork first, then screw the pole into the base fork.

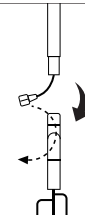

3. Find a Proper Location

1. Place the RTK antenna in an open area, away from houses and trees.
2. Ensure the distance between the RTK antenna and the charging station is within 10 m (32.8 ft).
3. Insert the RTK antenna into the ground and keep it upright and stable.

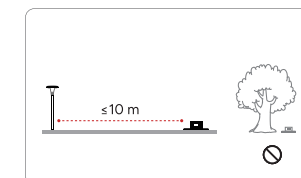
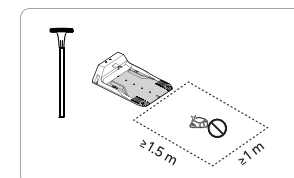
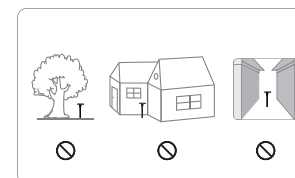
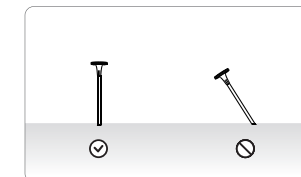
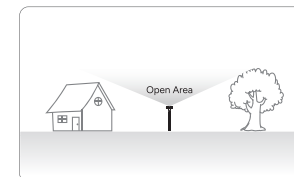
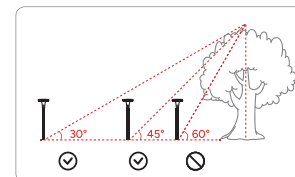

4. Connecting RTK Antenna to the Charging Station

1. Align the notch (A) on the charging station with the tab (B) on the antenna power cable.
2. Tighten the connectors.

Note: See the illustration on the right for positions A and B.

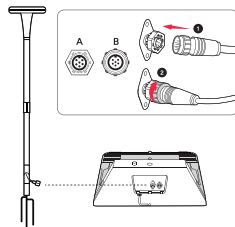

5. Pair RTK Antenna with Mower

1. Ensure the RTK antenna is properly connected to the charging station and that the charging station is connected to the power supply. Open the iGarden App → Go to the mower page → Settings → Working Settings.
2. Switch the positioning mode and enable RTK auto-pairing.
Working Settings → Positioning Mode → Switch to "Base Station" → Waiting for Restart → Scroll down and tap "Automatic Pairing".
3. After tapping "Automatic Pairing", the RTK will automatically pair with the mower.

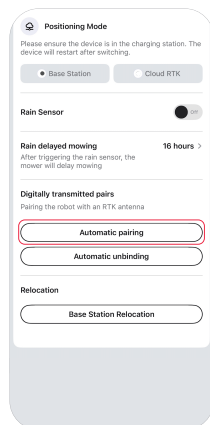
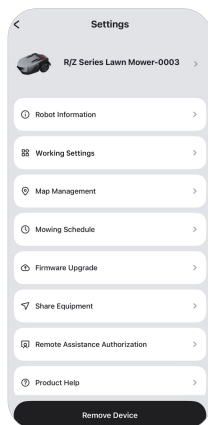

6. Check RTK Status and Complete Installation

Ensure the charging station is connected to the power supply. Check the RTK antenna indicator light. When the light is solid green, the installation is complete.

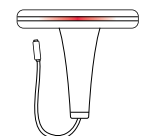

Red-flash
connect power supply

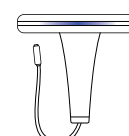

Blue-flash
searching satellite

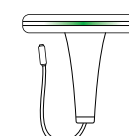

Green-solid
good signal

7. Recall the Mower

1. Press the black button on the charging station to recall the mower.
2. The mower will return to the charging station automatically.

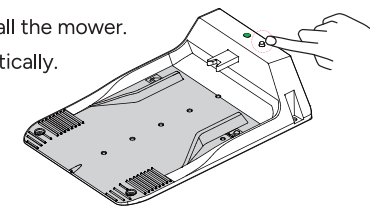

8. Installation Complete

The RTK antenna is ready to use.

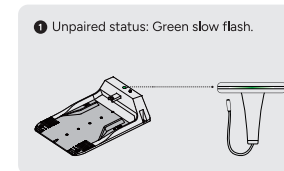

1 Unpaired status: Green slow flash.

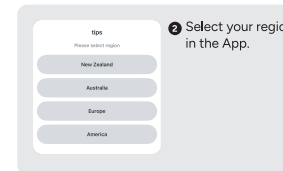

2 Select your region in the App.



3 When the instruction appears on your phone, press the button on the charging station.

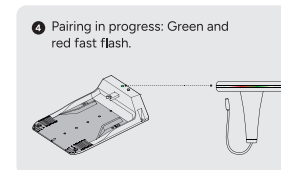

4 Pairing in progress: Green and red fast flash.

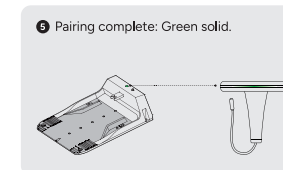

5 Pairing complete: Green solid.